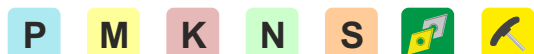
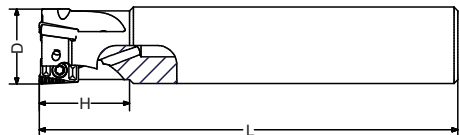

# M205-207D...

Shoulder milling cutters at 90°  
Fraises à dresser à 90°  
Schafffräser mit Zylinderschaft 90°  
Fresas para escuadrar à 90°

### Frese per spallamenti a 90° per inserto ADHX11T3

[illegible]

MATERIALI - MATERIALS		HB	fz (mm)	ap (mm)	Velocità di Taglio – Cutting Speed – Vc m/min							
							PM4325					
P	ACCIAIO NON LEGATO - NOT ALLOY STEEL	120-300	0,2	1-3			220					
	ACCIAIO LEGATO - ALLOY STEEL	180-350	0,15	1-3			200					
	ACCIAIO ALTO LEGATO - HIGH ALLOY STEEL	300-330	0,15	1-3			180					
M	INOX AUSTENITICO - DUPLEX - STAINLESS STEEL	180-230	0,1	1-3			140					
K	GHISA GRIGIA - GREY CAST IRON	120-260	0,25	1-3			180					
	GHISA SFEROIDALE - SPHEROIDAL CAST IRON	160-250	0,2	1-3			100					
	GHISA MALLEABILE - MALLEABLE CAST IRON	130-230	0,2	1-3			200					
N	ALLUMINIO E SUE LEGHE - ALUMINIUM	60-130	0,2	1-3								
	RAME E SUE LEGHE - COPPER	90-110	0,15	1-3								
	NON METALLICI - PLASTICS		0,15	1-3								
S	LEGHE RESIST. AL CALORE - HIGH TEMP. ALLOY	200-320	0,1	1-3								
	TITANIO E SUE LEGHE - TITANIUM	400-1050	0,1	1-3								

### Tipo di lavorazione - Recommended machining types

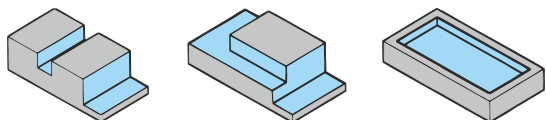
 $F \times 5$ 

L 2 - L 7

