

# MASK40TW...

ISO 40 - DIN 69871 A modular spindle  
 Broche modulaire DIN 69871 A - ISO 40  
 SK40 - Aufnahme DIN 69871 A  
 Cono modular DIN 69871 A - ISO 40

Mandrino modulare DIN 69871 A - ISO 40 per Testine di fresatura

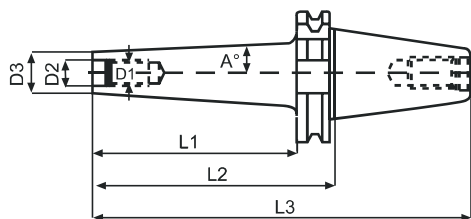

Codice Code	Attacco Attack	Dimensioni / Dimensions						
		D1	D2	D3	L1	L2	L3	A°
MASK40TW1-C	SK40	M8	8.5	13	50	68	137.5	2°
MASK40TW1-H	SK40	M8	8.5	13	100	118	187.5	2°
MASK40TW2-C	SK40	M10	10.5	18	50	68	137.7	3°
MASK40TW2-H	SK40	M10	10.5	18	100	118	187.5	3°
MASK40TW2-M	SK40	M10	10.5	18	150	168	237.5	2°
MASK40TW3-C	SK40	M12	12.5	21	50	68	137.5	3°
MASK40TW3-H	SK40	M12	12.5	21	100	118	187.5	3°
MASK40TW3-M	SK40	M12	12.5	21	150	168	237.5	2°
MASK40TW4-E	SK40	M16	17	28	75	93	162.5	2°
MASK40TW4-K	SK40	M16	17	28	125	143	212.5	2°
MASK40TW4-M	SK40	M16	17	28	150	168	237.5	3°
MASK40TW4-Q	SK40	M16	17	28	175	193	262.5	3°

Testine utilizzabili / Heads available

L 2 - L 7



Twister 01  
pag. F 50



Twister 03  
pag. F 51



Twister 11  
pag. F 54



Twister 31  
pag. F 56



Twister 04  
pag. F 52



Twister 06  
pag. F 53



Twister 16  
pag. F 55