

# CCGL...20/30/40/50/60-A

Cartucce per scanalatura radiale con inserto 2 / 3 / 4 / 5 / 6 mm / Cartridges for radial grooving with 2 / 3 / 4 / 5 / 6 mm inserts

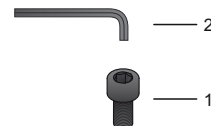
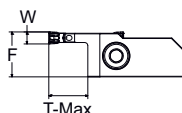
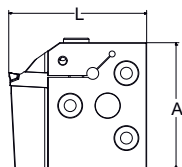

Codice Articolo Item Code	T-max	L	A	F	W	Inserto Insert	Peso Weight	Prezzo Price
<b>CCGL 20 09-A</b>	09	43	42	14	2,0	CTSN 22-20	0,13 kg	€ 104,00
<b>CCGL 20 18-A</b>	18	52	42	14	2,0	CTSN 22-20	0,14 kg	€ 109,00
<b>CCGL 30 10-A</b>	10	44	42	14,5	3,0	CTSN 22-30	0,13 kg	€ 104,00
<b>CCGL 30 20-A</b>	20	54	42	14,5	3,0	CTSN 22-30	0,14 kg	€ 109,00
<b>CCGL 40 12-A</b>	12	46	42	15	4,0	CTSN 25-40	0,13 kg	€ 104,00
<b>CCGL 40 24-A</b>	24	58	42	15	4,0	CTSN 25-40	0,14 kg	€ 109,00
<b>CCGL 50 15-A</b>	15	50	42	15,5	5,0	CTSN 25-50	0,14 kg	€ 109,00
<b>CCGL 50 30-A</b>	30	65	42	15,5	5,0	CTSN 25-50	0,15 kg	€ 113,00
<b>CCGL 60 20-A</b>	20	55	42	16	6,0	CTSN 25-60	0,14 kg	€ 109,00
<b>CCGL 60 40-A</b>	40	75	42	16	6,0	CTSN 25-60	0,16 kg	€ 113,00

Base / Basements

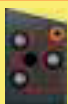

MTS-...-B1B4C-A | p. 28

Parti di Ricambio / Spare Parts



VB0624

€ 4,00



CBR40

€ 4,00

Direzione rotazione: Oria / Clock wise rotation

Troncatura  
Cut-Off

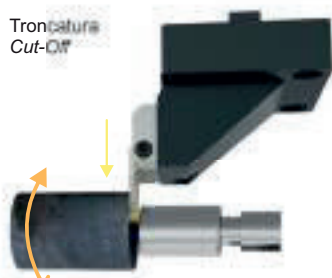

Scanalatura  
Grooving

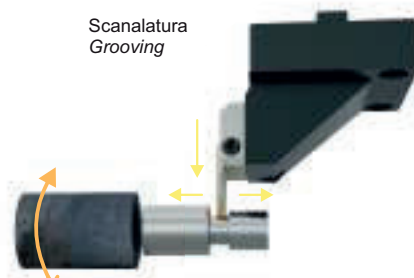

# CCGR...20/30/40/50/60-B

Cartucce per scanalatura radiale con inserto 2 / 3 / 4 / 5 / 6 mm / Cartridges for radial grooving with 2 / 3 / 4 / 5 / 6 mm inserts

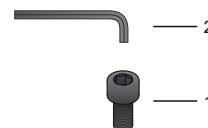
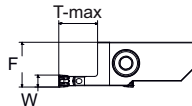
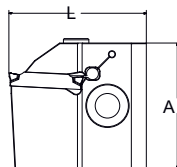

Codice Articolo Item Code	T-max	L	A	F	W	Inserto Insert	Peso Weight	Prezzo Price
<b>CCGR 20 09-B</b>	09	43	42	14	2,0	CTSN 22-20	0,13 kg	€ 104,00
<b>CCGR 20 18-B</b>	18	52	42	14	2,0	CTSN 22-20	0,14 kg	€ 109,00
<b>CCGR 30 10-B</b>	10	44	42	14,5	3,0	CTSN 22-30	0,13 kg	€ 104,00
<b>CCGR 30 20-B</b>	20	54	42	14,5	3,0	CTSN 22-30	0,14 kg	€ 109,00
<b>CCGR 40 12-B</b>	12	46	42	15	4,0	CTSN 25-40	0,13 kg	€ 104,00
<b>CCGR 40 24-B</b>	24	58	42	15	4,0	CTSN 25-40	0,14 kg	€ 109,00
<b>CCGR 50 15-B</b>	15	50	42	15,5	5,0	CTSN 25-50	0,14 kg	€ 109,00
<b>CCGR 50 30-B</b>	30	65	42	15,5	5,0	CTSN 25-50	0,15 kg	€ 113,00
<b>CCGR 60 20-B</b>	20	55	42	16	6,0	CTSN 25-60	0,14 kg	€ 109,00
<b>CCGR 60 40-B</b>	40	75	42	16	6,0	CTSN 25-60	0,16 kg	€ 113,00

Base / Basements



MTS-...-B2B3C-B | p. 28

Parti di Ricambio / Spare Parts



VB0624

€ 4,00



CBR40

€ 4,00

Direzione rotazione Antioraria / Counter clock wise rotation

Troncatura  
Cut-Off

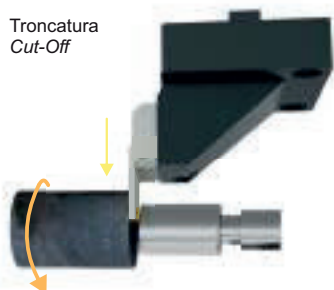

Scanalatura  
Grooving

