

SRDCN

External turning tools
Outils de tournage extérieur
Werkzeuge für Aussenbearbeitung
Utensilios para torneado exterior

Utensili per tornitura esterna

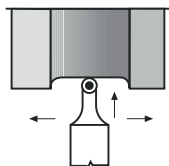
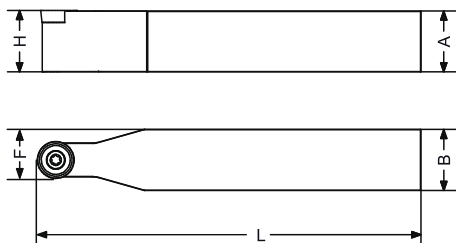

Codice Code	Dimensioni / Dimensions					Inserto Insert	Parti di Ricambio / Spare Parts	
	F	H	B	A	L			
SRDCN 1616H 06	11	16	16	16	100	RC..0602	TX2506	BTX08
SRDCN 2020K 06	13	20	20	20	125	RC..0602	TX2506	BTX08
SRDCN 2525M 06	15.5	25	25	25	150	RC..0602	TX2506	BTX08
SRDCN 1616H 08	12	16	16	16	100	RC..0803	TX3007	BTX08
SRDCN 2020K 08	14	20	20	20	125	RC..0803	TX3007	BTX08
SRDCN 2525M 08	16.5	25	25	25	150	RC..0803	TX3007	BTX08
SRDCN 2020K 10	15	20	20	20	125	RC..1003	TX3007	BTX15
SRDCN 2525M 10	17,5	25	25	25	150	RC..1003	TX3007	BTX15
SRDCN 2020K 12	16	20	20	20	125	RC..1204	TX3511	BTX15
SRDCN 2525M 12	18,5	25	25	25	150	RC..1204	TX3511	BTX15

MATERIALI - MATERIALS		HB	fz (mm)	ap (mm)	Velocità di Taglio - Cutting Speed - Vc m/min							
					CT9325			PT8130	WT1010			
P	ACCIAIO NON LEGATO - NOT ALLOY STEEL	120-300	0,2	1-3	200			180				
	ACCIAIO LEGATO - ALLOY STEEL	180-350	0,15	1-3	150			140				
	ACCIAIO ALTO LEGATO - HIGH ALLOY STEEL	300-330	0,15	1-3	120			100				
M	INOX AUSTENITICO - DUPLEX - STAINLESS STEEL	180-230	0,1	1-3				120				
K	GHISA GRIGIA - GREY CAST IRON	120-260	0,25	1-3								
	GHISA SFEROIDALE - SPHEROIDAL CAST IRON	160-250	0,2	1-3								
	GHISA MALLEABILE - MALLEABLE CAST IRON	130-230	0,2	1-3								
N	ALLUMINIO E SUE LEGHE - ALUMINIUM	60-130	0,2	1-3					1500			
	RAME E SUE LEGHE - COPPER	90-110	0,15	1-3					400			
	NON METALLICI - PLASTICS		0,15	1-3					200			
S	LEGHE RESIST. AL CALORE - HIGH TEMP. ALLOY	200-320	0,1	1-2								
	TITANIO E SUE LEGHE - TITANIUM	400-1050	0,1	1-2								

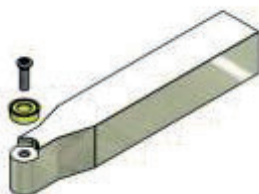

B x 9



L 2 - L 7

